

THIS DRAWING IS UNPUBLISHED. RELEASED FOR PUBLICATION .19 .
 © COPYRIGHT 19 BY AMP INCORPORATED. ALL RIGHTS RESERVED.

LOC	DIST	REVISIONS			
P	LTR	DESCRIPTION	DATE	DWN	APVD
FT	0	P			
		P	REDRAWN & ADDED -11 PER EC 063C-234-99	22 DEC 99	-

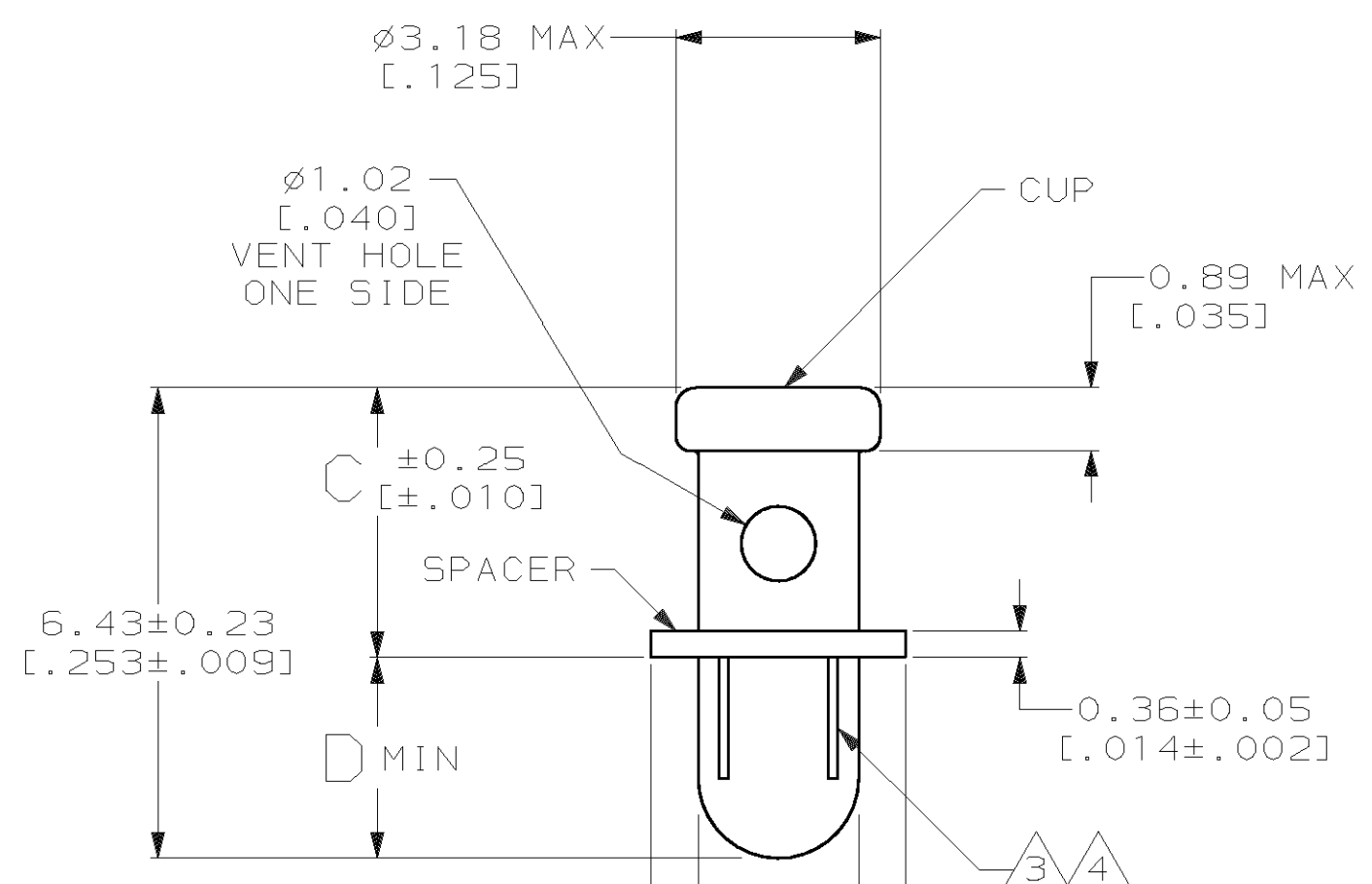
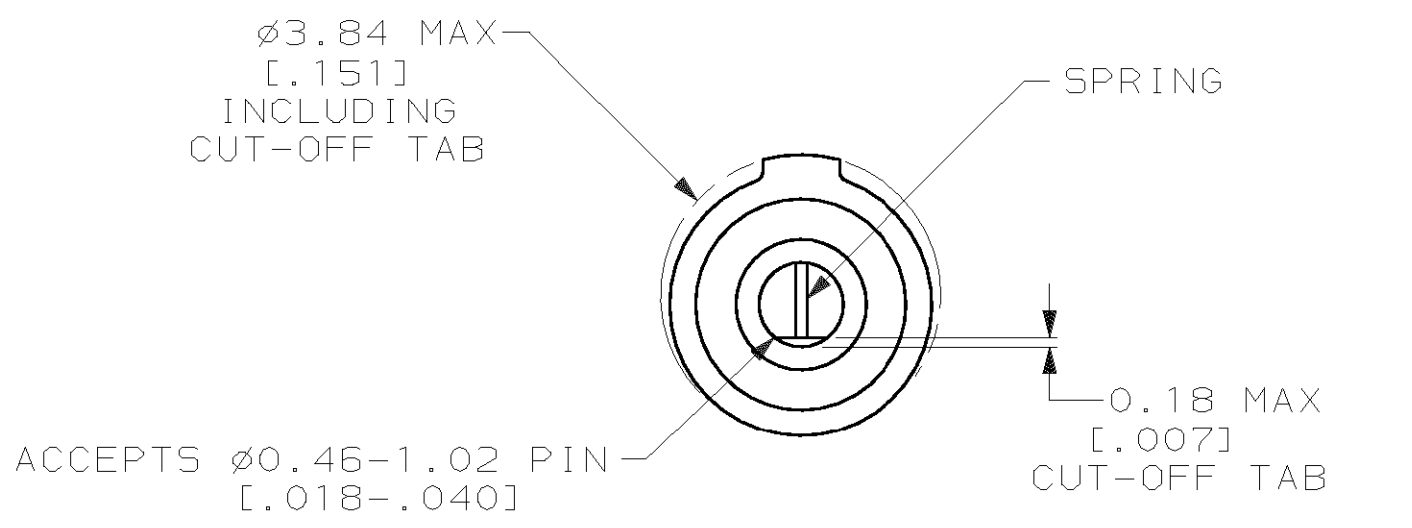

- 1 CUP: COPPER.
SPACER: BRASS.
SPRING: BERYLLIUM COPPER.
- 2 CUP: 2.54 μ m [.000100] MIN TIN-LEAD.
SPACER: 2.03 μ m [.000080] MIN TIN-LEAD OVER
1.27 μ m [.000050] MIN NICKEL.
SPRING: GOLD FLASH OVER 1.27 μ m [.000050] MIN NICKEL.
0.76 μ m [.000030] MIN GOLD IN CONTACT AREA.
- 3 4 BARE LINES 90° APART ON OUTSIDE OF CUP.
- 4 $\phi 2.11$ [.083] MIN ACROSS BARE METAL.
- 5 FITS INTO $\phi 2.261 \pm 0.038$ [.0890 \pm .0015] HOLE,
FOR HAND INSERTION.
- 6. 3.68 [.145] MIN INSERTION DEPTH FOR RELIABLE CONTACT
OF COMPONENT LEAD.
- 7. AFTER SIZING WITH PIN "A", SAME PART MUST MEET
EXTRACTION FORCE WITH PIN "B".

PIN "A" DIA	MAX INSERTION FORCE GRAMS [OUNCES]	PIN "B" DIA	MIN EXTRACTION FORCE GRAMS [OUNCES]
0.51 [.020]	482 [17]	0.46 [.018]	28.3 [1.0]
0.81 [.032]	1049 [37]	0.64 [.025]	42.5 [1.5]
1.02 [.040]	1361 [48]	0.89 [.035]	56.7 [2.0]

8 PRELIMINARY - NOT RELEASED FOR PRODUCTION.

2.90 [.114]	3.05 [.120]	1-380737-1 8
2.16 [.085]	3.68 [.145]	1-380737-0
D	C	PART NUMBER

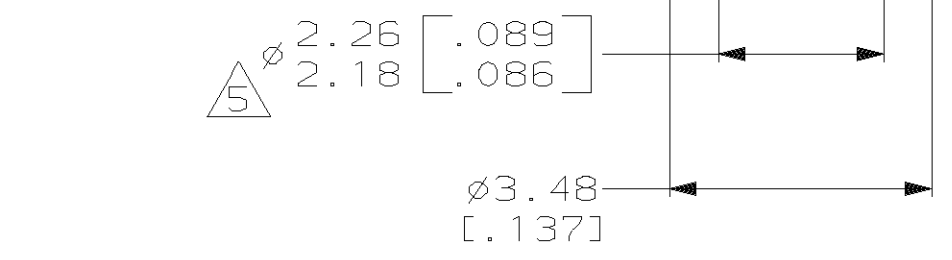

THIS DRAWING IS A CONTROLLED DOCUMENT.

DWN D.HARDY 22 DEC 99	AMP AMP Incorporated Harrisburg, PA 17105-3608
CHK H.WYNKOOP 19 JAN 00	
APVD H.WYNKOOP 19 JAN 00	NAME
PRODUCT SPEC	RECEPTACLE ASSEMBLY, REUSABLE COMPONENT
APPLICATION SPEC	SIZE CAGE CODE DRAWING NO RESTRICTED TO
WEIGHT -	A3 00779 C- 380737 -
CUSTOMER DRAWING	SCALE 10:1 SHEET 1 OF 1 REV P

DIMENSIONS: mm [INCHES]
 TOLERANCES UNLESS OTHERWISE SPECIFIED:
 0 PLC \pm -
 1 PLC \pm -
 2 PLC ± 0.38 [.015]
 3 PLC \pm -
 4 PLC \pm -
 ANGLES $\pm 1^\circ$
 MATERIAL 1 FINISH 2